

Top View

Scale 1:20

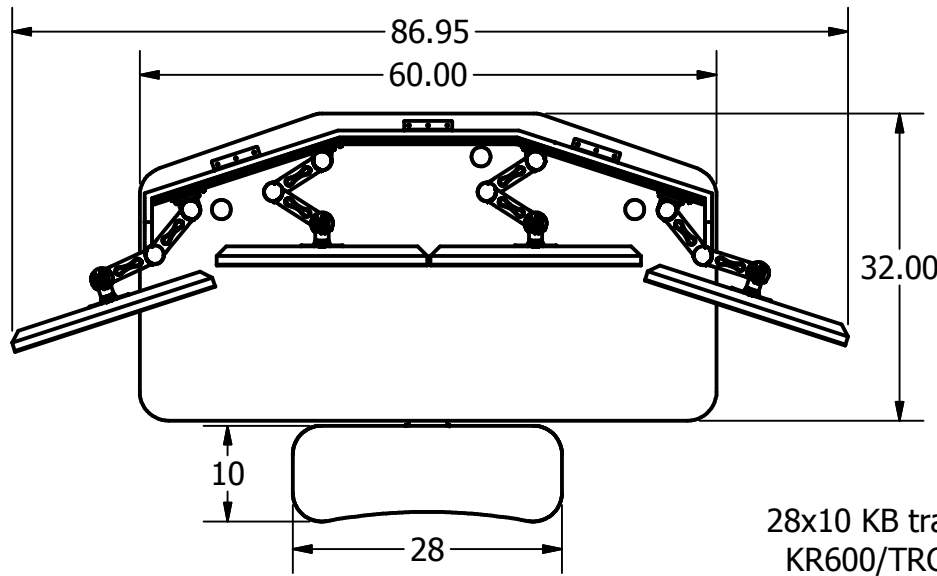

(3) Ø2" Grommet Holes

(4) AFCZ6-66 VESA 75/100 Compliant Monitor Holders on Slatwall Bracket

Slatwalls (2) Row high

28x10 KB tray KR600/TRCS

Enclosure with front and rear hinged doors for CPU

(4) CPUs installed inside:
Computer #1: 6" W x 14" H x 11" D
Computer #2: 4" W x 11.5" H x 12" D
Computer #3: 7" W x 14" H x 17" D
Computer #4: 2" W x 9" H x 9" D

2" Grommets on sides

Front View

Scale 1:20

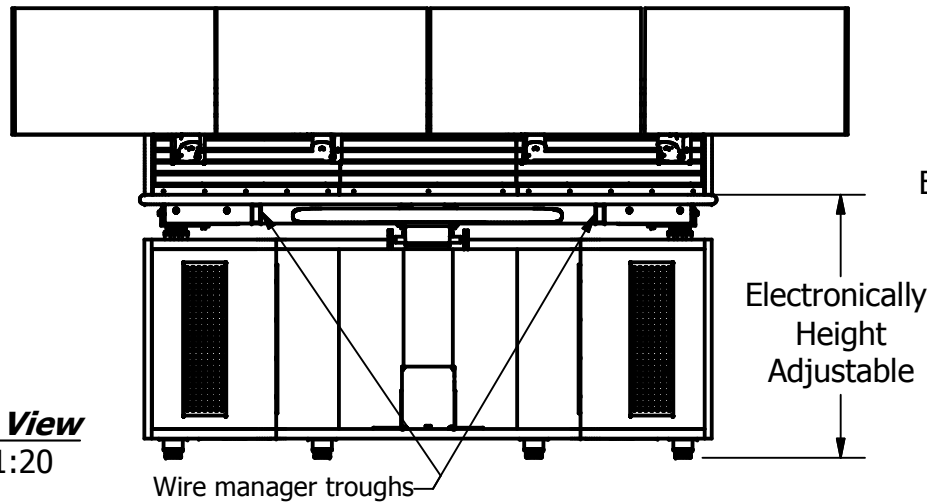

FCS11_6030-01-V8

ISO View

Scale 1:15

NOTES:
Final Design May Vary
23" Monitors shown

Tolerances:
Height ±1"
Surface Dims. ± 0.5"

SHEET 1 OF 2
SCALE: As Shown

DATE: 12/15/2020

DESCRIPTION:

DRAWN BY: RR

P/N: FCS11_6030-01-V8.idw

PATH: L:\PP&T-DWG\1 INVENTOR CONTENT
CENTER\Library\FinalAssem-SoldToCustomers\Ergonomic
Consoles\Focus\FCS11_6030-01-V8\FCS11_6030-01-V8.idw

Bottom View
Scale 1:20

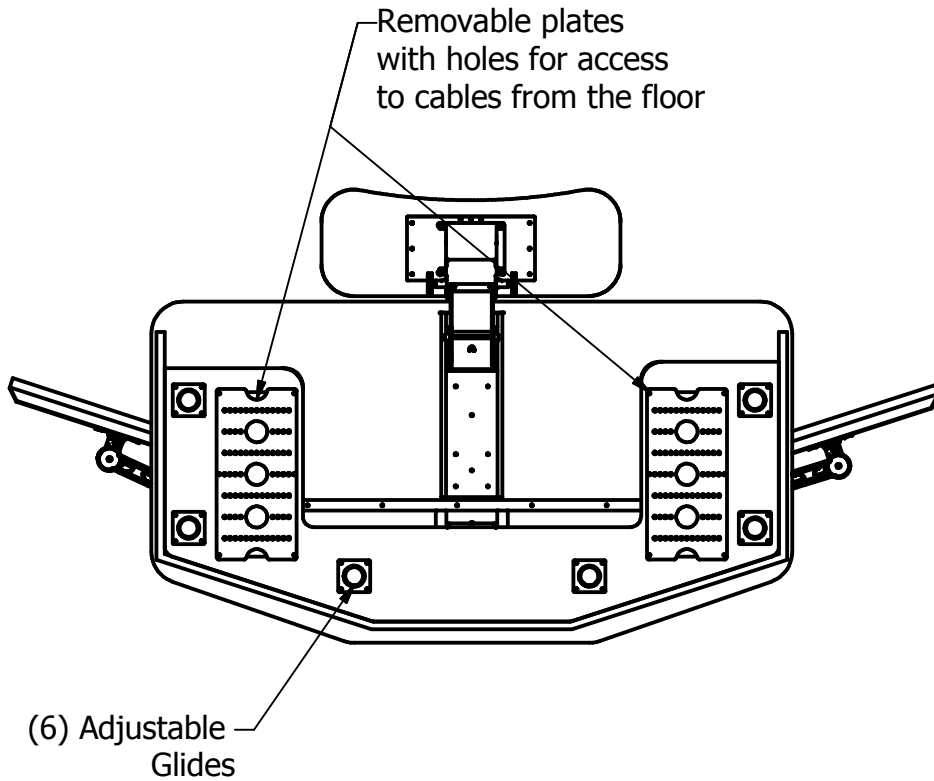

Slatwall

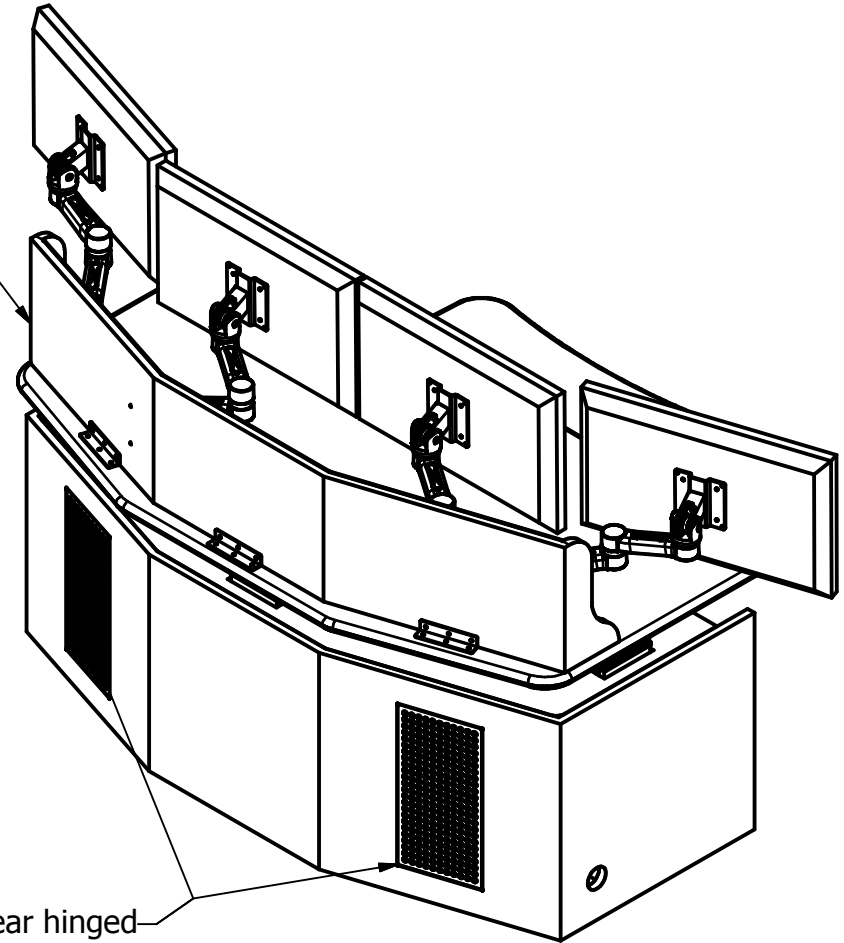

REAR ISO View
Scale 1:15

FCS11_6030-01-V8

NOTES:
Final Design May Vary

Tolerances:
Height $\pm 1"$
Surface Dims. $\pm 0.5"$

SHEET 2 OF 2
SCALE: As Shown

DATE: 12/15/2020

DRAWN BY: RR

DESCRIPTION:

P/N: FCS11_6030-01-V8.idw

PATH: L:\PP&T-DWG\1 INVENTOR CONTENT
CENTER\Library\FinalAssem-SoldToCustomers\Ergonomic
Consoles\Focus\FCS11_6030-01-V8\FCS11_6030-01-V8.idw